

Model: ID12

Install instruction

① Recessed Mounted Installation

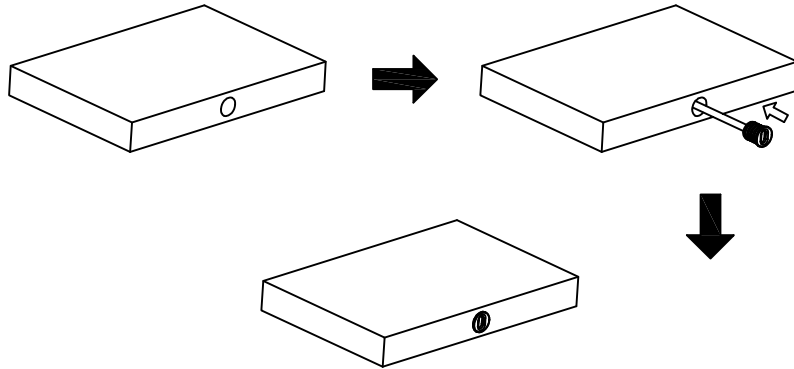

Instruction of the connecting power

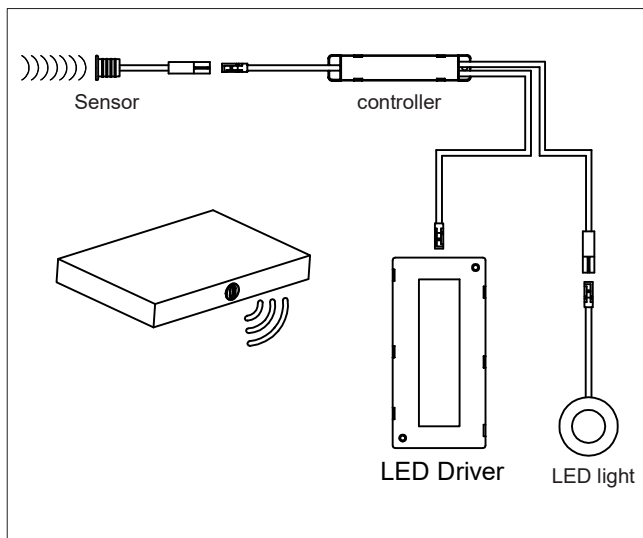

Technical Data

- Dimension: $\phi 12 \times 12 \text{mm}$
- Voltage: DC 12~24V
- Power: 12V/36W
24V/72W
- Sensing Distance: 2-60mm
- Protection Class: IP20

Assembly and Operating Instructions

INSTRUCTIONS (PLEASE SAVE)

This article is manufactured to comply with European quality & safety standards (CE, EN60598) and is suitable for indoor use as described in the installation manual. The packaging is made of environment friendly material and is 100% recyclable.

FITTING

- Before starting of the installation, turn off the main switch on the meter board to turn off power.
- Make a hole in the cabinet and place the sensor in the hole.
- Connect the feed wires as shown in the illustration.
- Sensor is suitable for installation in furniture conforming to Class III SELV (safety extra low voltage) standard.
- Only DC12~24V driver with correct specifications are recommended to be used with these fittings
- Sensor is suitable for use in domestic-type areas.
- It is not recommended to use this product in areas with moisture.

CAUTION!

- Do not connect the Sensor directly to the mains.
- Do not connect sensor to external driver, use only Vsunt recommended drivers with proper specifications.
- We recommend a qualified electrician to install the fitting.
- If the external flexible cable is damaged, it shall be replaced by the manufacturer or his service agent or a qualified electrician to avoid hazards.

MAINTENANCE

Maintenance should be limited to the surface of the sensor and care should be taken to avoid moisture from reaching the connection element or live wires. The sensor should be cleaned with a soft cloth. Do not use abrasives or solvents.